

CHEM THREAD® Fittings

INDEX

Adapters	7, 8	Elbows, 90°	.1	Laterals, 45°	.4
Blind Flanges	.3	Elbows, 45°	.2	Reducer Bushings	.3
Concentric Reducers	.5	End Caps	.5	Saddles	.6
Crosses	.7	Flanges	.3	Socket Couplings	.4
		Floor Drains	.6	Tees	.2

90° ELBOW (short radius & long radius)

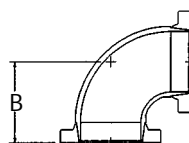
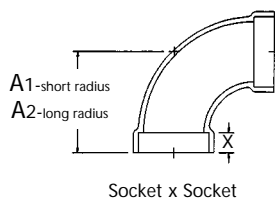

Nom. Pipe Size (In.)	A1 (In.)	A2 (In.)	B ⁽²⁾ (In.)	X (In. ± 1/16)	Nominal Wt. (Lbs.)		Max. Oper. Pressure ⁽⁵⁾ @ 225°F (psig)	
					Socket	Flanged	Socket	Flanged
1½	3 ¾	–	4	1 5/16	0.6	2.4	150	150
2	3 ¼	5 1/8	4 ½	1 13/16	1.0	3.4	150	150
3	5	6 7/8	5 ½	1 13/16	3.4	6.1	150	150
4	5 ¾	8 ¾	6 ½	1 13/16	4.4	9.1	150	150
6	6 1/8	11 ½	8	2	10.5	13.6	150	150
8	–	15 ½	9	3	17.0	28.9	150	150
10	–	19 ½	11	4	20.0	34.5	150	150
12	–	22 ½	12	4	28.0	68.0	150	150

Size (In.)	(mm)	(mm)	(mm ± 1.6)	(kg)		@ 107°C (MPa)	
				Socket	Flanged	Socket	Flanged
1½	86	–	102	0.3	1.1	1.0	1.0
2	83	130	114	0.5	1.5	1.0	1.0
3	128	175	140	1.8	2.8	1.0	1.0
4	136	213	165	2.5	4.1	1.0	1.0
6	156	292	203	5.4	6.2	1.0	1.0
8	–	394	229	7.7	13.1	1.0	1.0
10	–	495	279	9.1	15.6	1.0	1.0
12	–	572	305	12.7	30.8	1.0	1.0

(1) Flanges should be joined only to flat-faced flanges. See Smith Fibercast Manual No. E5000 for valve, bolt, and gasket recommendations. See CHEM THREAD Flange on page 3 of this bulletin for torquing recommendations and flange dimensions.

(2) Flanged elbows are short radius.

(3) Higher pressure ratings are available on special request.

CHEM THREAD® Fittings

45° ELBOW (short radius & long radius)

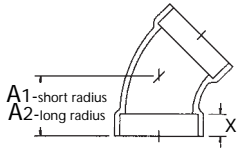

Socket x Socket

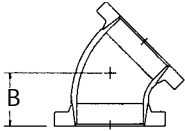

Flange x Flange⁽¹⁾

Nom. Pipe Size (In.)	A1 (In.)	A2 (In.)	B ⁽²⁾ (In.)	X (In. ± 1/6)	Nominal Wt. (Lbs.)		Max. Oper. Pressure ⁽³⁾ @ 225°F (psig)	
					Socket	Flanged	Socket	Flanged
1½	2 7/8	-	2 ¼	1 5/16	0.5	2.0	150	150
2	2 5/8	3 ¼	2 ½	1 13/16	0.9	2.6	150	150
3	4	3 7/8	3	1 13/16	2.9	4.9	150	150
4	4 1/8	4 ½	4	1 13/16	3.7	7.5	150	150
6	4 3/8	6 ¼	5	2	7.5	10.5	150	150
8	-	8 ½	5 ½	3	13.0	24.2	150	150
10	-	10 3/4	6 ½	4	13.5	36.0	150	150
12	-	12	7 ½	4	17.0	54.5	150	150

Size (In.)	(mm)	(mm)	(mm ± 1.6)	(kg)		@ 107°C (MPa)	
				Socket	Flanged	Socket	Flanged
1½	73	-	57	0.2	0.9	1.0	1.0
2	67	83	64	0.4	1.2	1.0	1.0
3	103	98	76	1.3	2.2	1.0	1.0
4	104	114	102	1.7	3.4	1.0	1.0
6	111	159	127	3.4	4.8	1.0	1.0
8	-	216	140	5.9	11.0	1.0	1.0
10	-	273	165	6.1	16.3	1.0	1.0
12	-	305	191	7.7	24.7	1.0	1.0

TEE

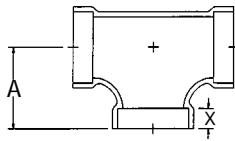

Socket x Socket x Socket

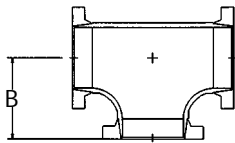

Flange x Flange x Flange⁽¹⁾

Nominal Pipe Size (In.)	A (In.)	B (In.)	X (In. ± 1/6)	Nominal Wt. (Lbs.)		Max. Oper. Pressure ⁽³⁾ @ 225°F (psig)	
				Socket	Flanged	Socket	Flanged
1½	3 3/8	4	1 5/16	0.9	3.6	150	150
2	3 ¼	4 ½	1 13/16	1.6	5.1	150	150
3	5	5 ½	1 13/16	5.4	9.3	150	150
4	5 3/8	6 ½	1 13/16	7.2	12.8	150	150
6	6 1/8	8	2	14.9	24.0	150	150
8	9 ½	9	3	30.0	43.0	150	150
10	12	11	4	29.1	75.0	150	150
12	12 ½	12	4	35.6	90.0	150	150

Size (In.)	(mm)	(mm)	(mm ± 1.6)	(kg)		@ 107°C (MPa)	
				Socket	Flanged	Socket	Flanged
1½	86	102	33	0.4	1.6	1.0	1.0
2	83	114	46	0.7	2.3	1.0	1.0
3	128	140	46	2.5	4.2	1.0	1.0
4	136	165	46	3.2	5.8	1.0	1.0
6	156	203	51	6.7	10.9	1.0	1.0
8	241	229	76	13.6	19.5	1.0	1.0
10	305	279	102	13.2	34.0	1.0	1.0
12	318	305	102	16.1	40.8	1.0	1.0

(1) Flanges should be joined only to flat-faced flanges. See Smith Fibercast Manual No. E5000 for valve, bolt, and gasket recommendations. See CHEM THREAD Flange on page 3 of this bulletin for torquing recommendations and flange dimensions.

(2) Flanged elbows are short radius.

(3) Higher pressure ratings are available on special request.

CHEM THREAD® Fittings

FLANGE⁽²⁾⁽³⁾

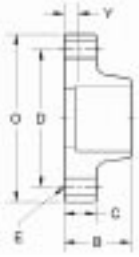

Nominal Pipe Size (In.)	B (In.)	C (In.)	D (In.)	E (In.)	F (In.)	O (In.)	Y (In.)	Recommended Torquing of Flanges Torque (ft•lbs)		Nom. Weight (Lbs.)		Max. Oper. Pressure ⁽¹⁾ @225°F (psig)	
								To Seal	Max.	F	BF	F	BF
1½	1¾	¾	3⅞	⅝ D-4 Holes	¾	5	¾	20	25	0.9	0.9	150	125
2	2¼	¾	4¾	¾ D-4 Holes	¾	6	¾	20	20	1.4	1.3	150	125
3	2⅝	1⅜	6	¾ D-4 Holes	1	7½	¾	20	20	2.3	2.5	150	125
4	2⅝	1⅜	7½	¾ D-8 Holes	1	9	¾	20	20	3.3	3.5	150	100
6	3	1½	9½	⅞ D-8 Holes	1⅞	11	¾	30	30	3.8	5.5	150	100
8	4	1⅜	11¾	⅞ D-8 Holes	1⅞	13½	¾	40	40	8.3	8.1	150	100
10	4⅝	2¼	14	1D-12 Holes	1¼	16	¾	40	40	14.3	13.8	150	75
12	4⅝	2¼	17	1D-12 Holes	1¼	19	¾	40	40	21.4	19.8	150	75

BLIND FLANGE⁽²⁾

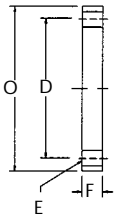

Pipe Size (In.)	B (mm)	C (mm)	D (mm)	E (mm)	F (mm)	O (mm)	Y (mm)	Torque (N•m)		(kg)		@107°C (MPa)	
								To Seal	Max.	F	BF	F	BF
1½	45	19	98	16D-4 Holes	19	127	9.5	27	34	0.4	0.4	1.0	0.9
2	57	19	121	19D-4 Holes	19	152	9.5	27	27	0.6	0.6	1.0	0.9
3	67	35	152	19D-4 Holes	25	191	9.5	27	27	1.0	1.1	1.0	0.9
4	67	35	191	19D-8 Holes	25	229	9.5	27	27	1.5	1.6	1.0	0.7
6	76	38	241	22D-8 Holes	29	279	9.5	41	41	1.7	2.5	1.0	0.7
8	102	35	298	22D-8 Holes	29	343	9.5	54	54	3.8	3.7	1.0	0.7
10	111	57	362	25D-12 Holes	32	406	9.5	54	54	6.5	6.3	1.0	0.5
12	111	57	432	25D-12 Holes	32	483	9.5	54	54	9.7	9.0	1.0	0.5

REDUCER BUSHING⁽⁴⁾⁽⁵⁾

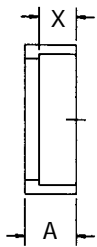

Reducer Size (In.)	A (In.)	X (In. ± ⅛)	Nominal Wt. (Lbs.)	Max. Oper. Pressure ⁽¹⁾ @ 225°F (psig)
2 x 1½	2	1 ⅝	0.3	125
3 x 2	2	1 ⅜	0.6	125
4 x 3	2	1 ⅜	1.0	100
6 x 4	2	1 ⅜	2.9	100
8 x 6	3	2	4.5	100
10 x 8	4¼	3	5.8	75
12 x 10	4¼	4	7.6	75

Size (In.)	(mm)	(mm ± 1.6)	Wt. (kg)	@ 107°C (MPa)
2 x 1½	51	33	0.1	0.9
3 x 2	51	46	0.3	0.9
4 x 3	51	46	0.5	0.7
6 x 4	51	46	1.3	0.7
8 x 6	76	51	2.0	0.7
10 x 8	106	76	2.6	0.5
12 x 10	106	102	3.4	0.5

(1) Higher pressure ratings are available on special request.

(2) Flanges should be joined only to flat-faced flanges. See Smith Fibercast Manual No. E5000 for valve, bolt, and gasket recommendations. See CHEM THREAD Flange on this page for torquing recommendations and flange dimensions.

(3) 1" - 6" flanges have small machined relief.

NOTE: All flanges are ANSI B16.5-150 lb. Bolt Hole Circle.

F = Flange

BF = Blind Flange

(4) 2" x 3/4" and 2" x 1" reducer bushings are available with female NPT outlet.

(5) Consult Smith Fibercast for recommended pressure rating when bonding multiple reducer bushings (e.g., a 3" x 2" reducer bushing inside a 4" x 3" reducer bushing).

CHEM THREAD® Fittings

SOCKET COUPLING

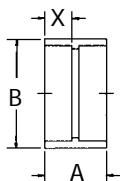

Nominal Pipe Size (In.)	A (In.)	B (In.)	X (In. ± 1/6)	Nominal Wt. (Lbs.)	Max. Oper. Pressure ⁽¹⁾ @ 225°F (psig)
1½	3	2 ¼	1 ⅝	0.2	150
2	4	2 ⅝	1 ⅞	0.3	150
3	4	3 ⅞	1 ⅞	0.6	150
4	4	4 ⅞	1 ⅞	1.0	150
6	4 ¾	7 ⅞	2	1.4	150
8	6 ¾	9 ¼	3	2.4	150
10	8 ¾	11 ½	4	4.2	150
12	8 ¾	13 ⅝	4	6.0	150

Size (In.)	(mm)	(mm)	(mm ± 1.6)	(kg)	@ 107°C (MPa)
1½	76	57	33	0.1	1.0
2	102	68	46	0.1	1.0
3	102	98	46	0.3	1.0
4	102	125	46	0.5	1.0
6	111	181	51	0.6	1.0
8	162	235	76	1.1	1.0
10	213	292	102	1.9	1.0
12	213	346	102	2.7	1.0

LATERAL

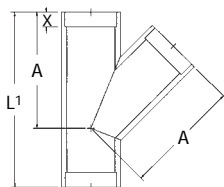

Socket x Socket x Socket

Nom. Pipe Size (In.)	A (In.)	B (In.)	L ¹ (In.)	L ² (In.)	X (In. ± 1/6)	Y (In.)	Nominal Wt. (Lbs.)		Max. Oper. Pressure @ 225°F* (psig)	
							Socket	Flanged	Socket	Flanged
1 ½	5 ½	8	8 ⅝	12	1 ⅝	4	2.2	4.4	150	150
2	6 ¼	10	10	16	1 ⅞	6	3.0	7.1	150	150
3	8 ½	12	13 ¼	18	1 ⅞	6	7.5	12.5	150	150
4	10 ½	14	16 ⅞	20	1 ⅞	6	13.8	19.1	125	125
6	13 ¼	16	19 ¼	24	2	8	17.4	32.1	125	125
8	16 ⅝	20	24	30	2	10	32.3	60.0	100	100
10	18	24	24 ¾	34	4	10	49.8	99.0	100	100
12	21 ¾	26	29 ¾	38	4	12	62.9	174.5	100	100

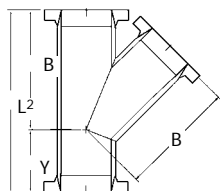

Flange x Flange x Flange⁽²⁾

Size (In.)	(mm)	(mm)	(mm)	(mm)	(mm ± 1.6)	(mm)	Wt. (kg)		@107°C* (MPa)	
							Socket	Flanged	Socket	Flanged
1 ½	138	203	218	305	33	102	1.0	2.0	1.0	1.0
2	160	254	252	406	46	152	1.4	3.2	1.0	1.0
3	217	305	335	457	46	152	3.4	5.7	1.0	1.0
4	267	356	408	508	46	152	6.3	8.7	0.9	0.9
6	336	406	490	610	51	203	7.9	14.6	0.9	0.9
8	423	508	611	762	51	254	14.7	27.2	0.7	0.7
10	456	610	618	864	102	254	22.6	44.9	0.7	0.7
12	552	660	756	965	102	305	28.5	79.2	0.7	0.7

(1) Higher pressure ratings are available on special request.

(2) Flanges should be joined only to flat-faced flanges. See Smith Fibercast Manual No. E5000 for valve, bolt, and gasket recom-

mendations. See CHEM THREAD Flange on page 3 of this bulletin for torquing recommendations and flange dimensions.

CONCENTRIC REDUCER⁽²⁾

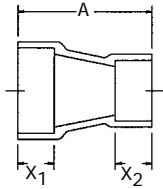

Socket x Socket

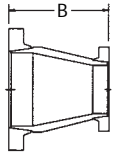

Flange x Flange⁽³⁾

Reducer Size (In.)	A (In.)	B (In.)	X ₁ (In. ± 1/16)	X ₂ (In. ± 1/16)	Nominal Wt. (Lbs.)		Max. Oper. Pressure ⁽¹⁾ @ 225°F (psig)	
					Socket	Flanged	Socket	Flanged
2 x 1½	5	5	1 13/16	1 5/16	0.5	2.3	150	150
3 x 1½	5 3/4	6	1 13/16	1 5/16	1.0	3.9	150	150
3 x 2	6	6	1 13/16	1 13/16	1.0	3.9	150	150
4 x 2	6 13/16	7	1 13/16	1 13/16	1.5	6.2	150	150
4 x 3	7	7	1 13/16	1 13/16	1.5	6.2	150	150
6 x 3	8 5/16	9	2	1 13/16	3.8	9.7	150	150
6 x 4	9	9	2	1 13/16	3.8	9.7	150	150
8 x 4	10 3/4	11	3	1 13/16	4.7	15.8	150	150
8 x 6	11 7/8	11	3	2	4.7	15.8	150	150
10 x 6	12 7/8	12	4	2	9.5	24.7	150	150
10 x 8	13 1/4	12	4	3	9.5	24.7	150	150
12 x 8	14 3/4	14	4	3	12.0	37.5	150	150
12 x 10	15 1/4	14	4	4	12.0	37.5	150	150

Size (In.)	(mm)	(mm)	(mm ± 1.6)	(mm ± 1.6)	Wt. (kg)		@ 107°C (MPa)	
					Socket	Flanged	Socket	Flanged
2 x 1½	127	127	46	33	0.2	1.0	1.0	1.0
3 x 1½	146	152	46	33	0.5	1.8	1.0	1.0
3 x 2	152	152	46	46	0.5	1.8	1.0	1.0
4 x 2	173	178	46	46	0.7	2.8	1.0	1.0
4 x 3	178	178	46	46	0.7	2.8	1.0	1.0
6 x 3	211	229	51	46	1.7	4.4	1.0	1.0
6 x 4	229	229	51	46	1.7	4.4	1.0	1.0
8 x 4	273	279	76	46	2.1	7.2	1.0	1.0
8 x 6	289	279	76	51	2.1	7.2	1.0	1.0
10 x 6	327	305	102	51	4.3	11.2	1.0	1.0
10 x 8	337	305	102	76	4.3	11.2	1.0	1.0
12 x 8	375	356	102	76	5.4	17.0	1.0	1.0
12 x 10	387	356	102	102	5.4	17.0	1.0	1.0

END CAP

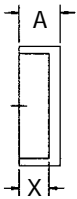

Nominal Pipe Size (In.)	A (In.)	X (In. ± 1/16)	Nominal Wt. (Lbs.)	Max. Oper. Pressure @ 225°F* (psig)
1 ½	2 5/8	1 5/16	0.6	150
2	2 3/4	1 13/16	1.3	150
3	3 1/4	1 13/16	1.8	150
4	3 3/4	1 13/16	3.0	150
6	4 1/2	2	3.9	150

Size (In.)	(mm)	(mm ± 1.6)	Wt. (kg)	@ 107.2°C* (MPa)
1 ½	67	33	0.3	1.0
2	70	46	0.6	1.0
3	83	46	0.8	1.0
4	95	46	1.4	1.0
6	114	51	1.8	1.0

(1) Higher pressure ratings are available on special request.

(2) Eccentric reducers are available on special order.

(3) Flanges should be joined only to flat-faced flanges. See Smith

Fibercast Manual No. E5000 for valve, bolt, and gasket recommendations. See CHEM THREAD Flange on page 3 of this bulletin for torquing recommendations and flange dimensions.

CHEM THREAD® Fittings

SADDLES⁽¹⁾

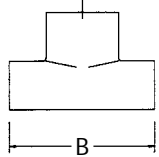
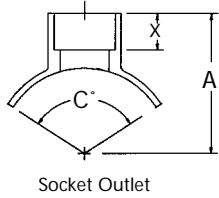

Nominal Size (In.)	A (In.)	X (In.)	B (In.)	C Angle (°)	Nom. Weight (Lbs.)	Max. Oper. Pressure ⁽²⁾ @ 225°F* (psig)	A (mm)	X (mm)	B (mm)	Nom. Weight (kg)	Max. Oper. Pressure @107°C* (MPa)
2 x 1½	2 15/16	1 5/16	4	180	0.4	125	74	33	102	0.2	0.9
3 x 1½	3 ½	1 5/16	6	180	1.0	125	89	33	152	0.5	0.9
3 x 2	4	1 13/16	6	180	1.0	125	102	46	152	0.5	0.9
4 x 1½	4	1 5/16	6	180	1.1	100	102	33	152	0.5	0.7
4 x 2	4 ½	1 13/16	6	180	1.3	100	114	46	152	0.6	0.7
4 x 3	5 ¼	1 13/16	6	180	1.6	100	133	46	152	0.7	0.7
6 x 1½	5 5/16	1 5/16	6	120	1.0	100	129	33	152	0.5	0.7
6 x 2	5 9/16	1 13/16	6	120	1.1	100	141	46	152	0.5	0.7
6 x 3	6 5/16	1 13/16	6	120	1.3	100	160	46	152	0.6	0.7
6 x 4	6 7/16	1 13/16	8	140	2.0	100	164	46	203	0.9	0.7
8 x 2	6 7/8	1 13/16	9	120	2.2	100	175	46	229	1.0	0.7
8 x 3	6 7/8	1 13/16	14	180	4.8	100	175	46	356	2.2	0.7
8 x 4	6 7/8	1 13/16	14	180	4.9	100	175	46	356	2.2	0.7
8 x 6	7 15/16	2	14	180	6.3	100	186	51	356	2.9	0.7
10 x 2	7 15/16	1 13/16	9	95	2.2	75	202	46	229	1.0	0.5
10 x 3	7 15/16	1 13/16	14	150	5.0	75	202	46	356	2.3	0.5
10 x 4	7 15/16	1 13/16	16 3/4	180	6.8	75	202	46	425	3.1	0.5
10 x 6	8 15/16	2	16 3/4	180	8.1	75	227	51	425	3.7	0.5
10 x 8	8 15/16	2	16 3/4	180	9.6	75	227	51	425	4.4	0.5
12 x 2	8 7/8	1 13/16	10	90	2.6	75	225	46	254	1.2	0.5
12 x 3	8 7/8	1 13/16	14	125	5.0	75	225	46	356	2.3	0.5
12 x 4	8 7/8	1 13/16	17	155	7.0	75	225	46	432	3.2	0.5
12 x 6	9 15/16	2	21	180	11.0	75	252	51	533	5.0	0.5
12 x 8	9 15/16	2	21	180	12.4	75	252	51	533	5.6	0.5
12 x 10	11 15/16	4	21	180	13.0	75	303	102	533	5.9	0.5

FLOOR DRAIN

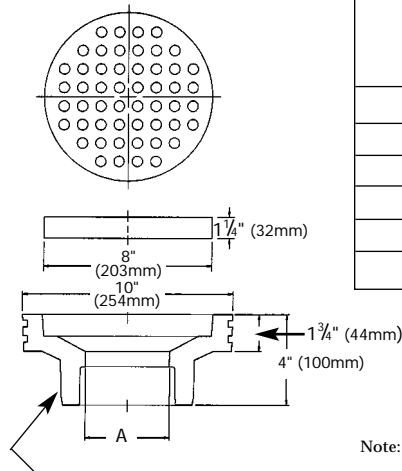

Must be machined to order for secondary containment.

Nominal Pipe Size A (In.)	Nominal Pipe Size A (mm)
2	51
3	76
4	100
6	128
3 x 4	76 x 100
4 x 6	100 x 128

Note: Floor drain grate is capable of supporting forklift loads.

(1) Saddles are available with 1" and 3/4" female NPT outlets on special order.

(2) Higher pressure ratings are available on special request.

CHEM THREAD® Fittings

CROSS

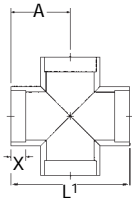

Socketed

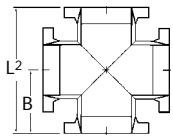

Flanged⁽²⁾

Nom. Pipe Size (In.)	A (In.)	B (In.)	L ¹ (In.)	L ² (In.)	X (In. ± 1/6)	Nominal Wt. (Lbs.)		Max. Oper. Pressure ⁽¹⁾ @ 225°F* (psig)	
						Socket	Flanged	Socket	Flanged
1 1/2	3	5	6	10	1 5/16	2.0	5.4	150	150
2	3 7/8	6	7 3/4	12	1 13/16	3.2	8.8	150	150
3	4 5/8	7	9 1/4	14	1 13/16	6.3	15.0	150	150
4	5 1/4	8	10 1/2	16	1 13/16	7.3	20.0	125	125
6	6 5/8	10	13 1/4	20	2	14.6	31.1	125	125
8 ⁽³⁾	7 7/8	12	15 3/4	24	2	28.6	60.0	100	100
10 ⁽³⁾	11 1/8	14	22 1/4	28	4	28.8	80.5	100	100
12 ⁽³⁾	12 1/4	16	24 1/2	32	4	65.0	142.0	100	100

Size (In.)	(mm)	(mm)	(mm)	(mm)	(mm ± 1.6)	Wt. (kg)		@ 107°C* (MPa)	
						Socket	Flanged	Socket	Flanged
1 1/2	76	127	152	254	33	0.9	2.5	1.0	1.0
2	98	152	197	305	46	1.5	4.0	1.0	1.0
3	117	178	235	356	46	2.9	6.8	1.0	1.0
4	133	203	267	406	46	3.3	9.1	0.9	0.9
6	168	254	337	508	51	6.6	14.1	0.9	0.9
8 ⁽³⁾	200	305	400	610	51	13.0	27.2	0.7	0.7
10 ⁽³⁾	283	356	565	711	102	13.1	36.5	0.7	0.7
12 ⁽³⁾	311	406	622	813	102	29.5	64.4	0.7	0.7

ADAPTER

Plain End x Male NPT

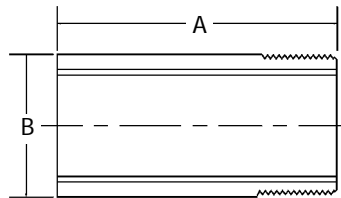

Nominal Pipe Size (In.)	A (In.)	B (In.)	Nominal Wt. (Lbs.)	Max. Oper. Pressure ⁽¹⁾ @ 275°F (psig)
2	8	2 3/8	0.4	150

Size (In.)	(mm)	(mm)	Wt. (kg)	@ 135°C (MPa)
2	203	60	0.2	1.0

(1) Higher pressure ratings are available on special request.
 (2) Flanges should be joined only to flat-faced flanges. See Smith Fiberglass Products Manual No. E5000 for valve, bolt, and gasket recommendations. See CHEM THREAD Flange on page 3 of this bulletin for torquing recommendations and flange dimensions.

(3) Four holes in 8", 10", and 12" flanged fittings are recessed for clearance during assembly. The recessed depths are 1/2" (13 mm) for 8", 5/8" (16 mm) for 10", and 3/4" (19 mm) for 12". Subtract these depths from overall flange thickness to determine flange thickness in these areas.

All dimensions listed in this brochure are nominal in nature and should only be used for system layout and take off. Actual fittings and fabrication work should be measured before bonding to ensure dimensional accuracy. Smith Fibercast does not warrant and is in no way responsible for the installation of the goods and shall not be responsible for the workmanship of any distributor, contractor or others involved in the installation of the goods.

It is the policy of Smith Fibercast to improve its products continually. In accordance with that policy, the right is reserved to make changes in specifications, descriptions, and illustrative material contained in this bulletin as conditions warrant. The information contained herein is general in nature and is not intended to express any warranty of any type whatsoever, nor shall any be implied.

SMITH Fibercast™

A Varco Company

2700 West 65th Street
Little Rock, AR 72209
(501) 568-4010
Fax: (501) 568-4465

P.O. Box 968 • 25 South Main
Sand Springs, OK 74063
(800) 331-4406 or (918) 245-6651
Fax: (Local/International) (918) 245-7566
Fax: (800) 365-7473

<http://www.smithfibercast.com>

